



PRESSES

MECHANICAL • HYDRAULIC • SERVO

Ring Frame Presses

GR Series

110T - 315T



Safeties conform to:
CE (EN-16092 : 2018)
OSHA 1910.217
CSA-Z142

ISO 9001:2015

High Performance Sheet Metal Working

Rigidity • Precision • Reliability



RING FRAME PRESSES

GR Series

Features

Isgec Ring Frame Presses are designed for high rigidity & accuracy by using single straight-sided frames. These Frames are fabricated from tested quality Steel Plates and Stress Relieved ensuring fatigue free long life.

Guiding (6-Point) Slide for better guiding to ensure high precision operation & longer tool life.

Advantages

- IMPROVED DIE LIFE
- HIGH RIGIDITY

- HIGH ACCURACY
- EASY TO INTEGRATE WITH FEEDLINE EQUIPMENT

Precise and Vibration Free Transmission

Crank Shaft

Forged from Normalized Alloy Carbon Steel, Ultrasonically Tested.

CAD analysis ensures elimination of stress concentrations and metal fatigues.



Gear

Gears of drive train machined to precision grade, conforming to DIN Grade 7 or AGMA 10 and better, for smooth torque transmission and vibration free operation.

Pinion

Forged Alloy Steel, Hardened & Tempered, Ultrasonically Tested, Accurately Machined and Ground.

Connecting Rod

Steel Casted, Normalized and Ultrasonically Tested.

Flywheel

Dynamically balanced Flywheel for long life of bearings.



Accurate Slide & Guide

- Extra long six points guides to ensure accurate slide guiding.
- Non Ferrous Liners.
- Accurately machined on CNC Machines.

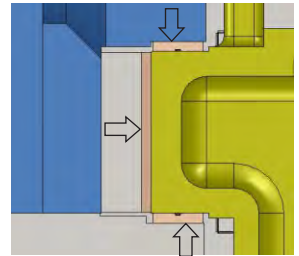

Hydraulic Overload Protection

Protection for Press and Dies

Hydraulically operated fast acting Over Load protection mechanism mounted on slide for better performance thereby preventing damage to the Press and Dies.

Motorized Slide Adjustment

Adjustment is driven by worm and worm wheel. Screw is machined on CNC centre for high accuracy and smooth profile.

Position is indicated on Mechanical indicator with an increment of 0.1 mm.



Operator Control Station

User friendly operator panel with touch screen HMI offers ease in data feeding as well as in fault diagnostics.



RING FRAME PRESSES

GR Series

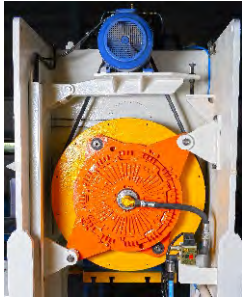

Pneumatic Clutch & Brake Assembly

- Pneumatically operated Clutch and Brake for easy maintenance and service.
- Clutch & Brake controlled by Dual Solenoid Valve.

Pneumatic Die Cushion

- Piston type Pneumatic Die Cushion ensures long life. It is maintenance friendly and easy to remove & install.
- Hardened grounded saddles on Die Cushion Pad area to ensure enhanced life and accuracy.



Motorised Grease Lubrication

- Automatic Grease Lubrication system lubricates Crank Shaft Bushes, Connecting Rod Bushes and Slide Guides.
- Oil Sump Lubrication for Main Gear Train for effective lubrication and heat dissipation.
- Lubrication is monitored through Progressive Lubrication Supply Line to give fault signals on HMI screen.

Wet Clutch can be provided on demand

Specifications

Model No.	Unit	GR-110T	GR-160T	GR-200T	GR-250T	GR-315T
Maximum Capacity	(kN)	1100	1600	2000	2500	3150
	(US Tons)	121	176	220	275	346
Rated Distance	(mm)	6	6	6	6	8
	(inch)	0.24	0.24	0.24	0.24	0.31
Speed (Fixed)	(SPM)	45	45	40	40	40
Speed (Variable)*#	(SPM)	30-60	30-60	25-50	25-50	25-50
Stroke Length (Fixed)	(mm)	180	200	200	250	250
	(inch)	7.1	7.9	7.9	9.8	9.8
Shut Height (s)	(mm)	350	500	550	600	600
Stroke Down Adjustment Up (SDAU)	(inch)	13.8	19.7	21.7	23.6	23.6
Slide Adjustment	(mm)	80	120	125	125	125
	(inch)	3.1	4.7	4.9	4.9	4.9
Slide Face (a x b)	(mm)	625 x 500	700 x 580	1000 x 650	1100 x 700	1100 x 700
	(inch)	24.6 x 19.7	27.6 x 22.8	39.4 x 25.6	43.3x27.6	43.3 x 27.6
Bolster Size (c x d)	(mm)	1150 x 710	1250 x 800	1450 x 850	1450 x 950	1450 x 950
	(inch)	45.3 x 28	49.2 x 31.5	57.1 x 33.5	57.1 x 37.4	57.1 x 37.4
Bolster Thickness (f)	(mm)	115	140	160	160	160
	(inch)	4.5	5.5	6.3	6.3	6.3
Height of Bolster Surface from Floor (g) approx.	(mm)	900	900	1000	1200	1200
	(inch)	35.4	35.4	39.4	47.2	47.2
Main Motor Power	(kW)	11	15	15	18.5	22
Die Cushion Capacity at 7 kg/sq.cm.*	(kN)	63	100	140	140	140
Die Cushion Stroke Length	(mm)	90	100	100	125	125
	(inch)	3.5	3.9	3.9	4.9	4.9
Die Cushion Pad Area	(mm)	500 x 450	600 x 450	600 x 560	600 x 560	600 x 560
	(inch)	19.7 x 17.7	23.6 x 17.7	23.6 x 22	23.6 x 22	23.6 x 22
Side Opening (k x j)	(mm)	525 x 425	575 x 425	600 x 425	600 x 525	600 x 525
	(inch)	20.7 x 16.7	22.6 x 16.7	23.6 x 18.7	23.6 x 20.7	23.6 x 20.7
Overall Dimension (n x l x m)	(mm)	3300 x 1700 x 1750	3600 x 2000 x 1850	4200 x 2500 x 1750	4700 x 2800 x 1750	4700 x 2800 x 1750
	(inch)	129.9 x 66.9 x 68.9	141.7 x 78.7 x 72.8	165.3 x 98.4 x 68.9	185 x 110.2 x 68.9	185 x 110.2 x 68.9

* Optional at extra cost.

Single stroke working is recommended up to mid SPM only.

- Dimensions given in inches are approximate

Standard Accessories

- Pneumatic Counter Balance Cylinders
- Hydraulic Overload Protection
- Motorized Slide Adjustment
- Automatic Forced Lubrication
- Operator Panel with PLC & HMI
- Pneumatic Clutch & Brake
- Emergency Stop Buttons
- Digital Shut Height Indicator
- Two Hand Push Button Station
- Production Counter
- Anti-Repeat Safety Device
- Rotary Cam Limit Switches (6 Nos.)
- Die Area Light
- Power Socket
- Photo Electric Guards

Optional Accessories

- Pneumatic Die Cushion
- Wet Clutch
- Variable Speed through AC Inverter
- Tonnage Monitor
- Quick Die Change System
- Anti Vibration Mounts
- Feedline Equipment (De-Coiler, Straightener, Feeder)
- Misfeed Detection Socket
- Metallic Guards & Covers
- Direct / Cam Operated Air Sockets
- Mechanical Knock Out
- Safety Block
- Automated Component Transfer System (ACTS)

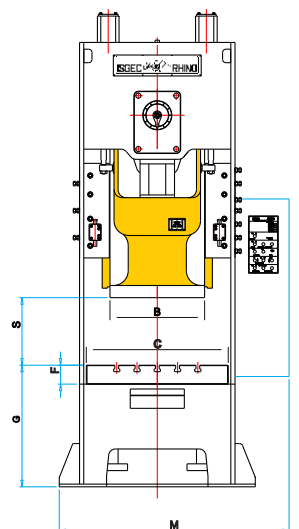
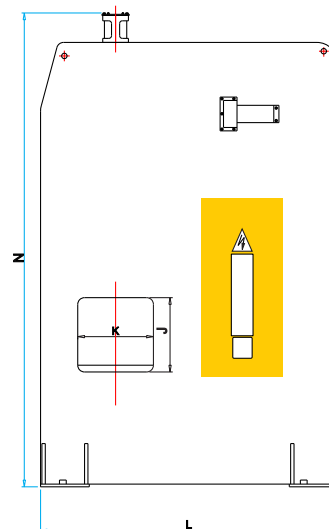

* Compliance with CE/OSHA Safety Regulations provided on demand

AFTER SALES SERVICE NETWORK

AHMEDABAD • BAWAL • BANGALORE • CHENNAI • DELHI
GURGAON • KOLKATA • MUMBAI • NOIDA • PUNE • YAMUNANAGAR



Wide Range of Presses

Servo Presses • Transfer Presses • Progressive Presses • High Speed Presses • Hot Stamping & Hot Forming Hydraulic Presses
Standard Straight Sided Mechanical & Hydraulic Presses • Blanking Lines • Tandem Press Lines - Mechanical & Hydraulic
Cold Forging Presses • Tryout & Die Spotting Presses • Gap Frame & Ring Frame Power Presses • Special Purpose Presses



www.isgrec.com



Follow us on:



Plant : Plot No. 123, Sector - 6, HSIIDC Growth Centre, Bawal - 123 501 (Haryana) India
Tel.: +91-8930234025
E-mail: smpbawal@isgrec.com, brijender@isgrec.com

Sales Office: **Gurgaon**
Unit No. 0705, (7th Floor), Emerald Plaza, Sector-65, Gurugram - 122 102 (Haryana) India
Tel.: +91-0124-405 2749 E-mail: smp.north@isgrec.com

Regional Offices: **Mumbai**
Great Social Building, Sir Phirozshah Mehta Road, Fort, Mumbai 400 001, India
Tel.: +91-22-22 66 23 74 Email: presses.wr@isgrec.com

Chennai
Grace Building, (3rd Floor), No 25, Mc Nichols Road, Chetpet, Chennai 600 031, India
Tel.: +91-44-28 36 13 75, 28 36 13 51 Email: presses.sr@isgrec.com

Kolkata
18, Main Road, Kalaniwas, Barrackpore, Kolkata 700 122, India
Tel.: +91-98363 61411 E-mail: presses.er@isgrec.com

Overseas Offices : Chonburi, Thailand • Windsor (Ontario), Canada • Portland (Tennessee), USA

Sales Representatives : Brazil • China • France • Germany • Hungary • Indonesia • Italy • Japan • Malaysia • Mexico
Poland • Russia • South Africa • Spain • Thailand • Turkey • USA • Vietnam